

21 205 9990 IM

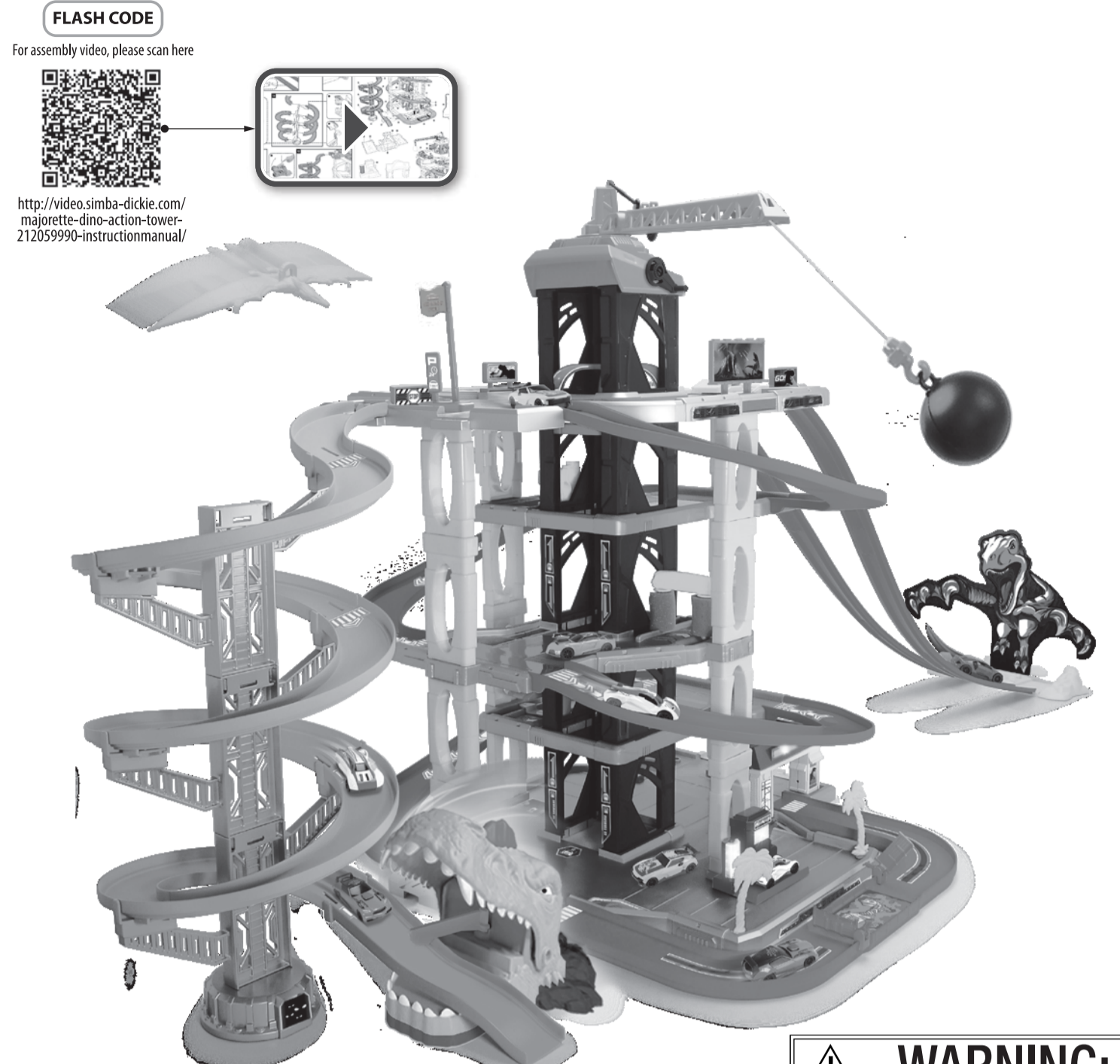
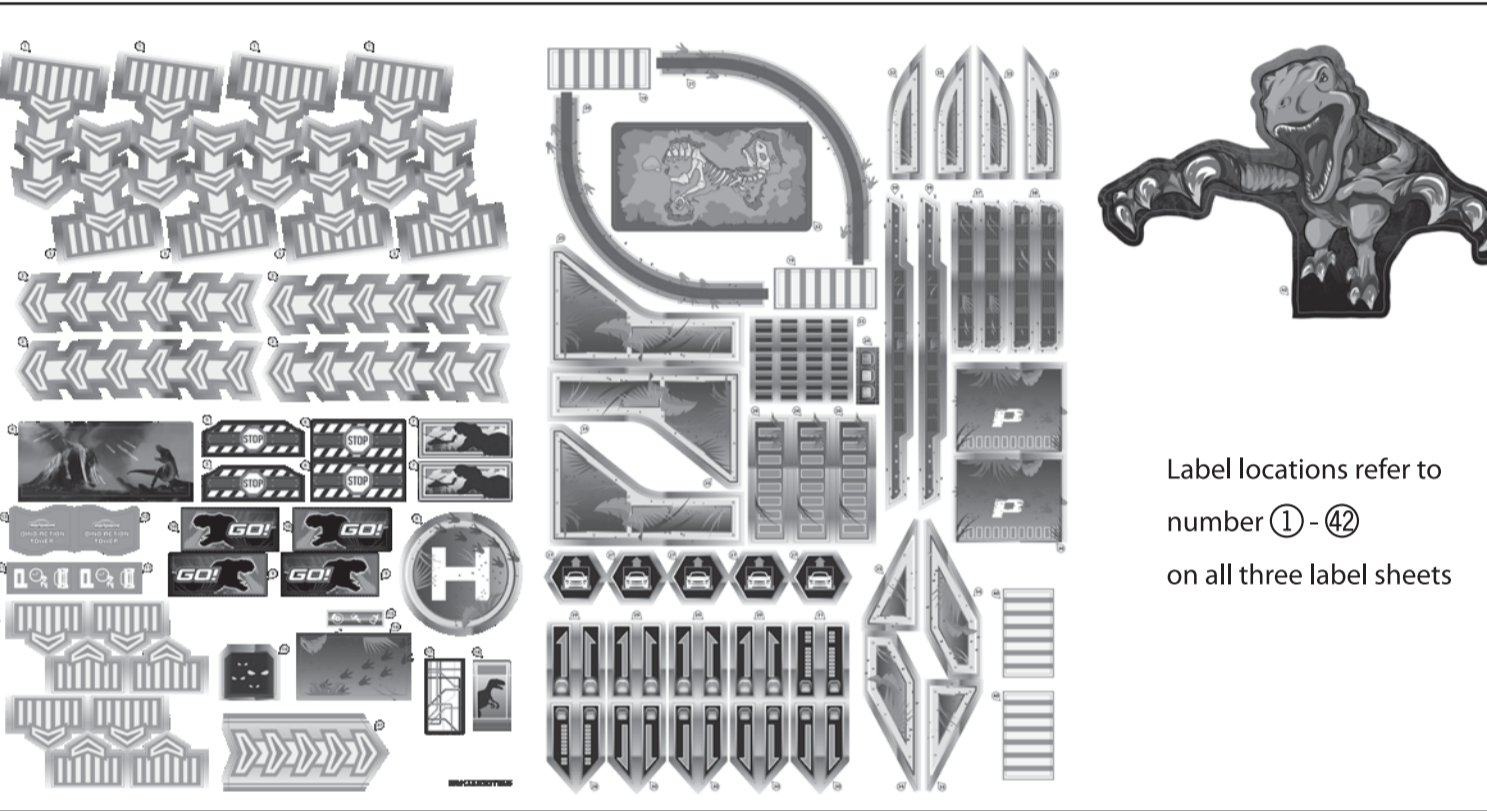
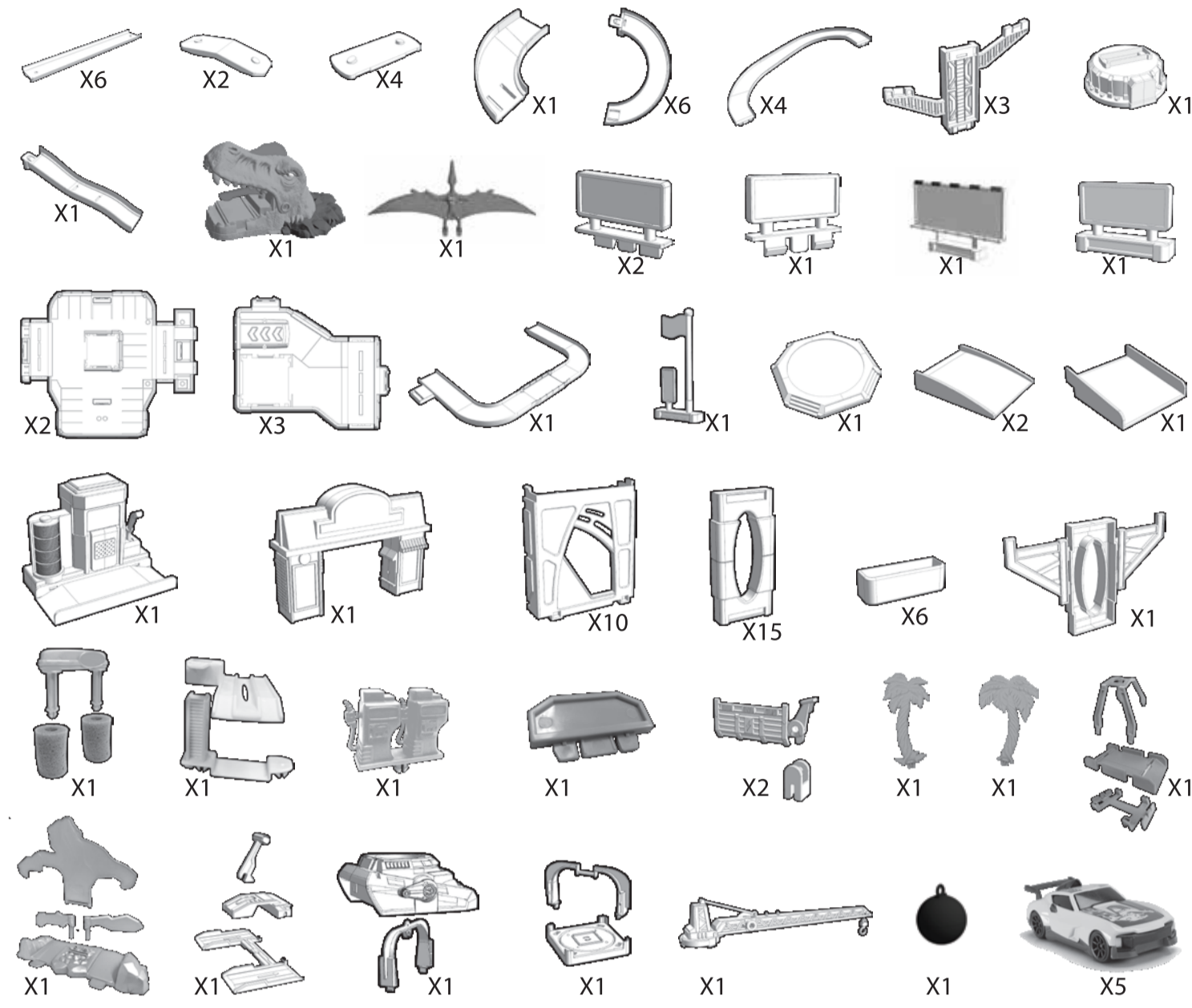

FLASH CODE
for assembly video, please scan here

<https://www.smba-dickie.com/majorette-direct-action-toys-212059990-instructionmanual/>

WARNING: CHOKING HAZARD - Small parts Not for children under 3 years FOR AGES 3+

4 x 1.5V R3/AAA (Battery not included)

WARNING!

- Please keep this information for any possible correspondence.
- Subject to mechanical change and change of color.
- Not suitable for children under three years.
- Choking hazard! Small parts may be swallowed!
- To be used under the direct supervision of an adult.
- Strangulation hazard due to the long cord!
- Electrical appliances are valuable products and should not be thrown in the dustbin when they reach the end of their serviceable life! Help us to protect the environment and respect our resources by handing this appliance over at the relevant recycling points. Questions related to this matter should be directed to the organization responsible for waste disposal or your specialist recycler.
- Only use the batteries specified!
- Put positive and negative poles in the right place!
- Do not throw away used batteries in the household garbage, but only give them to the collection station or dispose of them at a special recycling depot!
- Remove empty batteries from the toy.
- Non-rechargeable batteries must not be recharged.
- Do not use different types of batteries and do not mix new and used batteries.
- Do not use short-circuit connector clips.
- Do not mix old and new batteries.
- Do not mix alkaline, standard (carbon-zinc), or rechargeable batteries.

ATTENTION: You are advised to retain the packaging for future reference as it contains important information. All materials for fastening or packing purposes are not part of the toy and should be discarded for children's safety by an adult.

In the interest of better quality and value, we are constantly improving and updating our products, consequently, pictures on this package may sometimes differ from the model received.

R/N CODE: 02458/1
CE, ENEC, EHC, PAF, TIS 685-1997, PRODUCED BY MAJORETTE ITALIA AND CO., S.P.A., www.majorette.com

